

L.O.D. GENERAL NOTES:

1. THIS EXHIBIT IS DIAGRAMMATIC. IT IS INTENDED ONLY FOR THE PURPOSE OF INDICATING THE LOCATION OF THE DEMISED PREMISES WITHIN THE PROJECT. IT DOES NOT PURPORT TO SHOW THE EXACT OR FINAL LOCATION OF THE COLUMNS, WALLS, STOREFRONTS, OR OTHER ARCHITECTURAL, STRUCTURAL, MECHANICAL, ELECTRICAL OR PLUMBING ELEMENTS.
2. IT IS THE SOLE RESPONSIBILITY OF THE TENANT'S REPRESENTATIVE, ARCHITECT, CONTRACTOR, AND/OR ENGINEER TO FIELD VERIFY ALL CONDITIONS, DIMENSIONS, DOORS, STOREFRONTS, DEMISING WALLS, FIRE RATED ASSEMBLIES AND OTHER BUILDING COMPONENTS.
3. NEITHER THE LANDLORD NOR ITS AGENTS SHALL BE RESPONSIBLE FOR ANY INFORMATION CONTAINED, AND ANY REPRESENTATION MADE OR LOCATIONS/DIMENSIONS OR SPECIFICATIONS SHOWN HEREIN. THIS DOCUMENT IS FOR GENERAL INFORMATION AND APPROXIMATION PURPOSES ONLY.
4. SOME EXISTING BUILDING ELEMENTS ARE NOT SHOWN AND NO REPRESENTATION IS MADE WITH REGARD TO EXISTING CODE COMPLIANCE. TENANT SHALL HAVE THE SOLE RESPONSIBILITY FOR COMPLIANCE WITH ALL APPLICABLE STATUTES, CODES, ORDINANCES AND OTHER REGULATIONS.
5. ANSI/BOMA Z65.5-2010 RETAIL BUILDINGS:
STANDARD METHODS OF MEASUREMENT

THE WIDTH OF A TENANT SPACE IS DERIVED FROM THE CENTERLINE OF SHARED DEMISING WALLS TO THE CENTERLINE OF SHARED DEMISING WALLS, OUTSIDE FACE OF COMMON BUILDING CORRIDORS, MECHANICAL ROOMS, STAIRS, SHAFTS, OR EXTERIOR WALLS.

THE DEPTH OF A TENANT SPACE IS DERIVED FROM THE LEASE LINE TO THE CENTERLINE OF SHARED DEMISING WALLS, OUTSIDE FACE OF COMMON BUILDING CORRIDORS, MECHANICAL ROOMS, STAIRS, SHAFTS, OR EXTERIOR WALLS.

UTILITIES SUMMARY:

MECHANICAL:

Unit Type: TBD
Capacity: TBD
CW S&R:
Grease Exhaust: TBD
Non Grease Exhaust: TBD
Kitchen Hood: TBD
Outside Air: TBD

ELECTRICAL:

Service: TBD
Transformer: TBD
Panels: TBD

PLUMBING:

Domestic Water: TBD
Sanitary: TBD
Vent Size: TBD
Gas: TBD
Water Heater: TBD

RESTROOMS

TBD

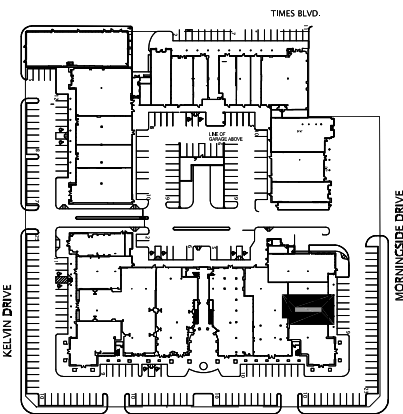

KEY PLAN - BLOCK C

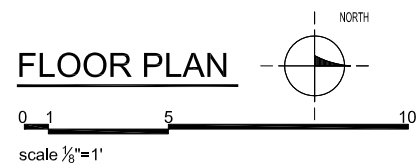
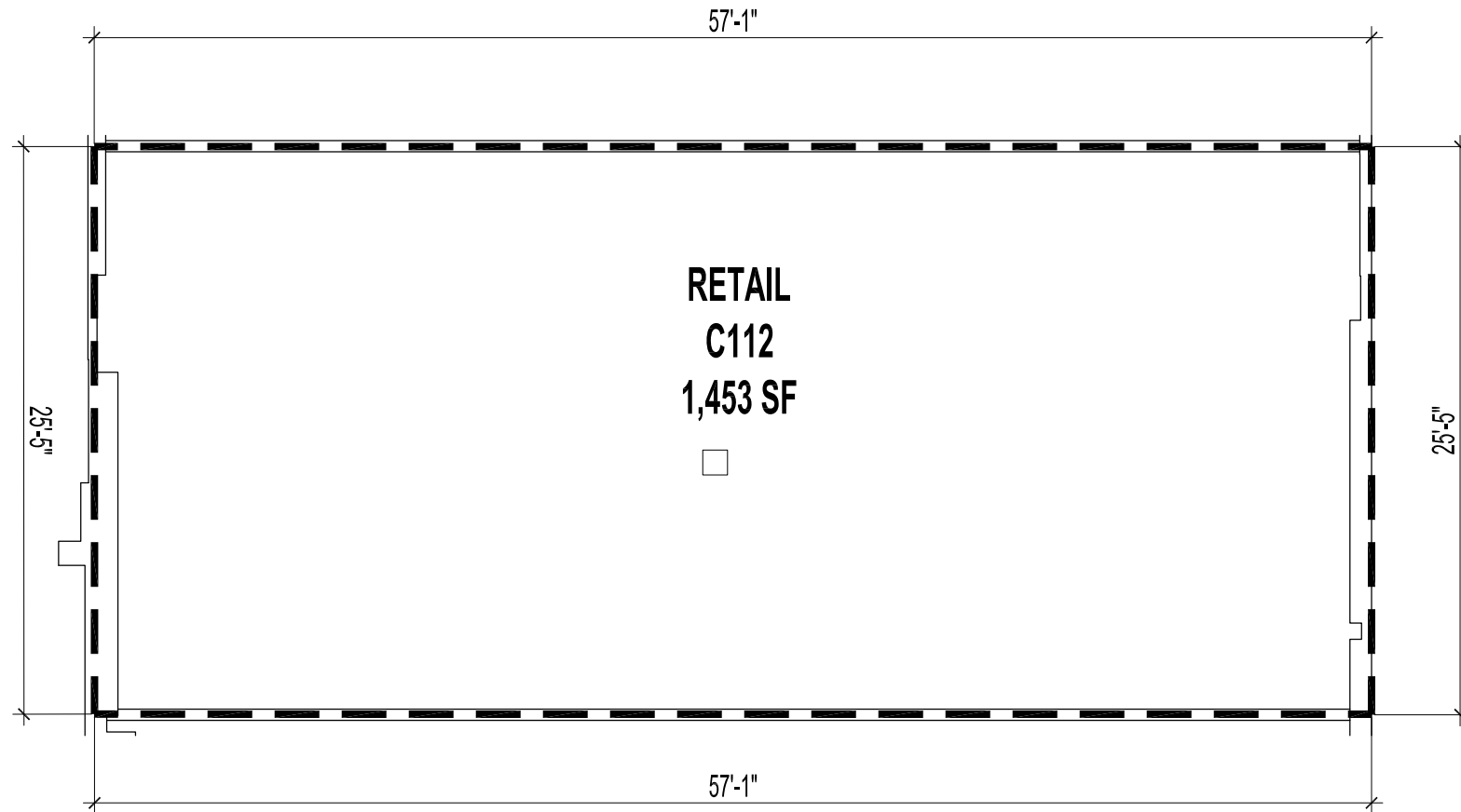

--- LEASELINE

RICE VILLAGE
HOUSTON, TEXAS

LEASE OUTLINE DRAWING SURVEY

DATE: October 23, 2019

SPACE #: C112

TENANT: RETAIL

LEASE AREA: 1,453

